

Capping Type	Front Face Length	Rear Face Length	Left Front Angle	Right Front Angle	Qty
A	2500	2500	90°	90°	1
B	2493	2493	90°	90°	1
C	2645	2645	90°	90°	1
D	1995	1995	90°	89.3°	1
E	827	740	87.5°	87.5°	2
F	822	735	87.4°	87.4°	9
G	245	245	90°	90°	1
H	968	1051	92.5°	92.5°	7
J	982	1070	92.5°	92.9°	1
K	224	224	90°	90°	1
L	780	698	87.5°	87.5°	10
M	825	736	87.3°	87.3°	2
N	908	819	87.3°	87.3°	1
P	764	670	87.6°	86.7°	1
R	2050	2050	90°	90°	1
S	2697	2697	90°	90°	3
T	2947	2947	90°	90°	1
U	2843	2843	90°	90°	1
V	1500	1500	90°	90°	1

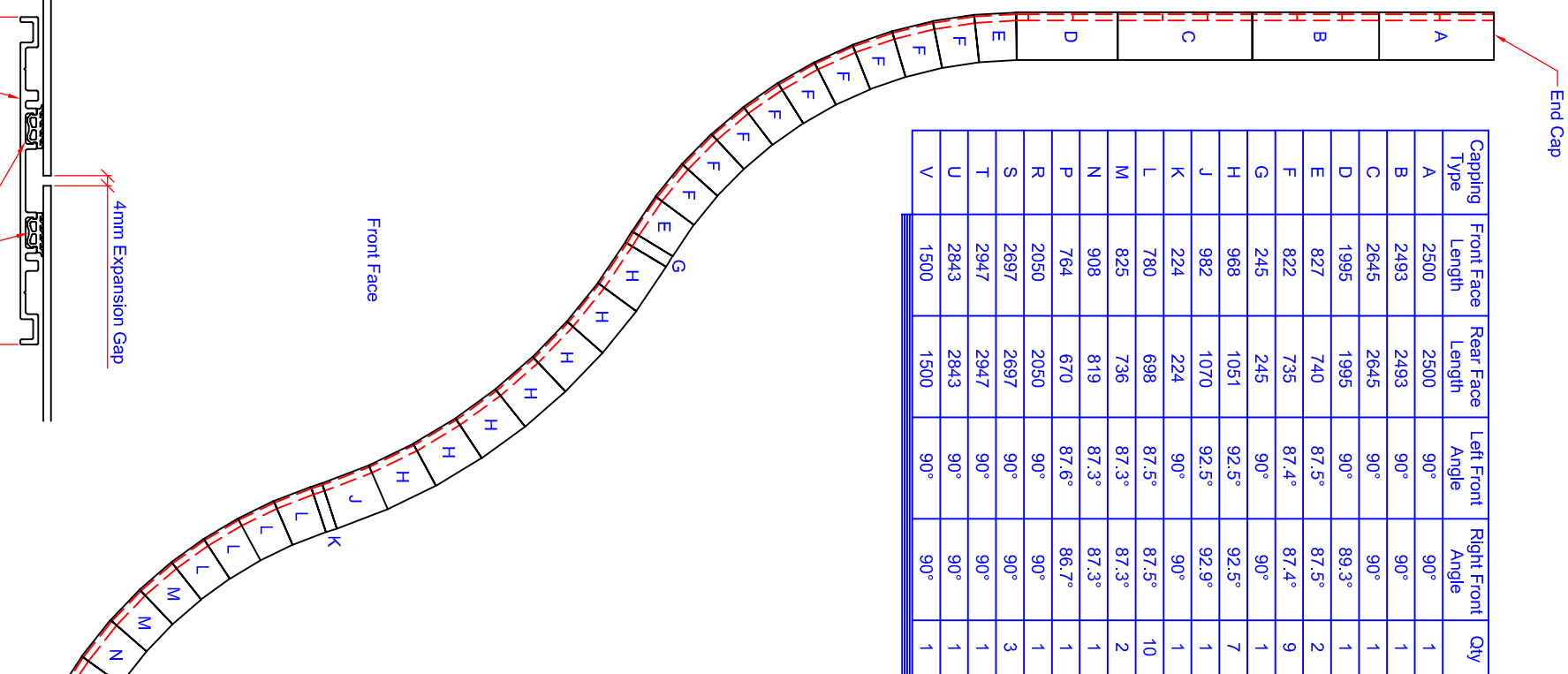

Typical Joint Detail (1:2)



Typical Capping Layout (1:75)

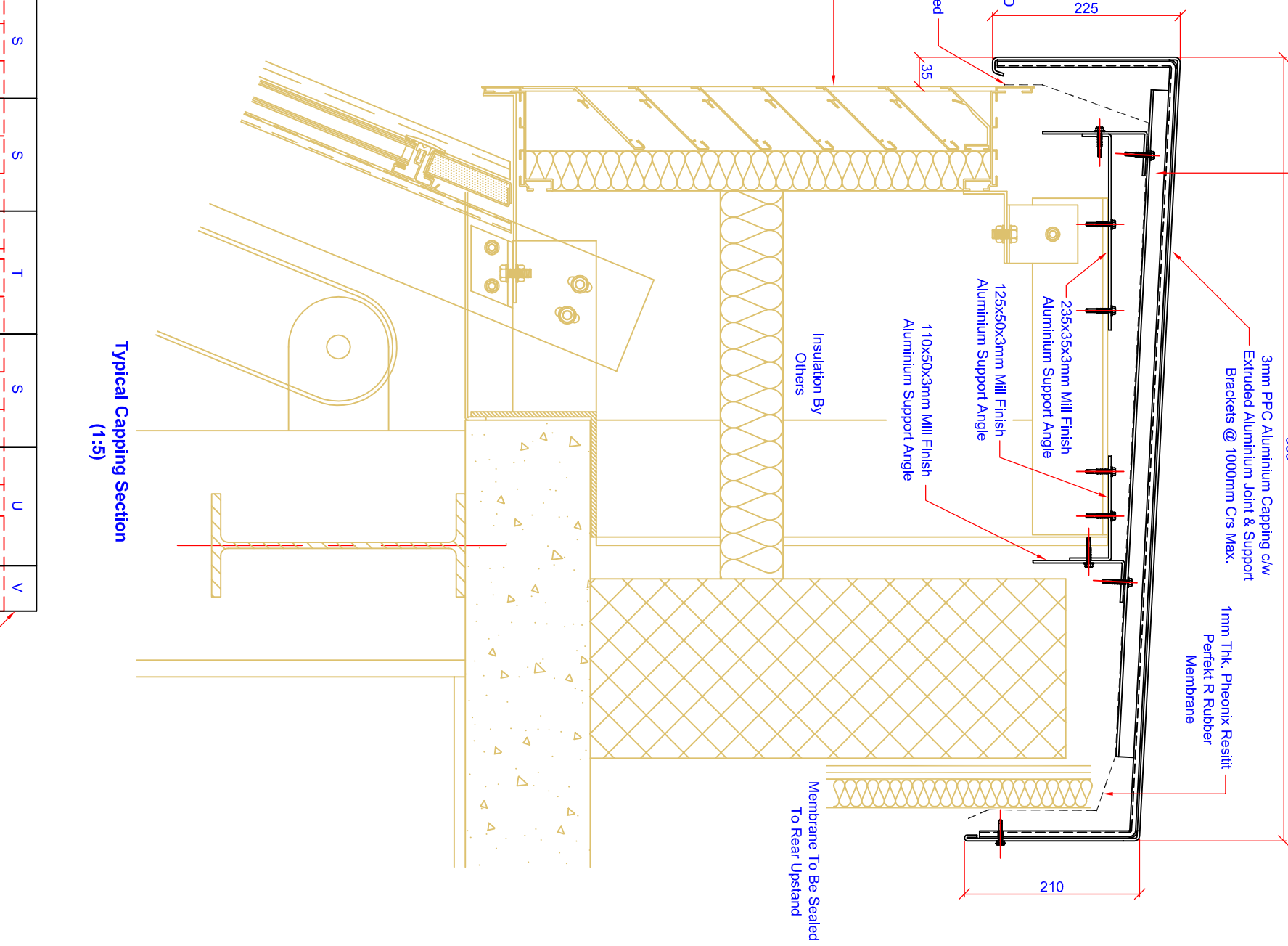

Typical Capping Section (1:5)

GENERAL NOTES
 ALL DIMENSIONS SUBJECT TO SITE MEASUREMENT
 ALL COLOURS TO BE ADVISED BY CONTRACTOR OR ARCHITECT
 TOUCH UP PAINT APPLIED TO ALL VISIBLE FASTENER HEADS
 ALL CUT ALUMINIUM PANELS/GUTTERS TO BE DE-BURRED & TOUCHED UP
 ISOLATION TAPE TO BE USED BETWEEN ALL DISSIMILAR MATERIALS
 UPVC PACKERS TO BE USED AS REQUIRED TO ACHIEVE A SUITABLE LINE & LEVEL
 ALL FIXINGS USED ARE TO @ 800mm C/s Max UNLESS OTHERWISE STATED ON THE DRAWING
 ALL ALUMINIUM PRODUCTS TO BE MANUFACTURED IN 3m LENGTHS UNLESS OTHERWISE STATED ON LAYOUT DRAWINGS

FIXING LIST
 F7 = 30mm HEX HEAD
 F42 = IRIS FIXING

Front Face

End Cap